

# STORK

---

## TECHNICAL DATASHEETS

# STORK

---

## INSTALLATION DETAILS FLOORING

STORK offers a choice of high-performance, lightweight floor solution for new builds and renovations. STORK flooring panels can be used to improve sound or thermal insulation.

Safe, easy on all types of substrate, including existing tiles, wooden floors, cement, gypsum and plasterboard.

Other flooring applications: Ship or Yacht decking, Illuminated dance floors, elevator floors.

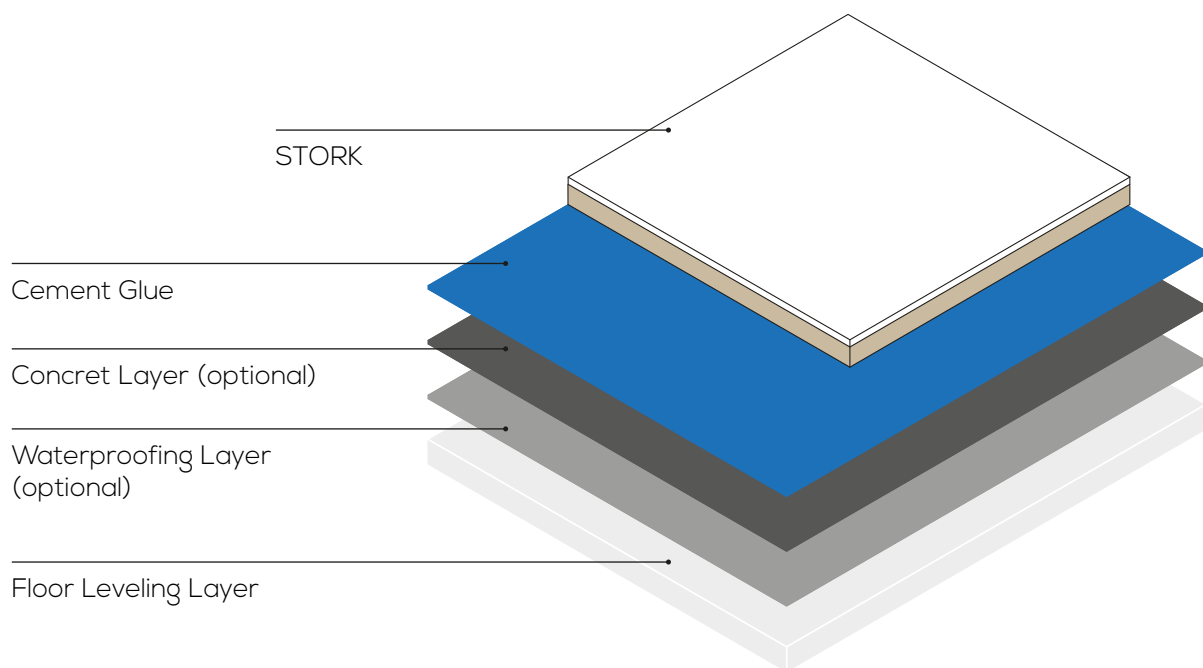

---

FURTHER QUESTIONS, ADVICE OR REQUESTS?  
**TALK TO US**

Detailed drawings and recommended texts for tender documentation of the shown examples are available on request. Do you need help or advice on a project? Contact our experienced technical services department – get in touch.

**PLEASE READ DISCLAIMERS:**

These guidelines are provided in good faith to help prevent any problems caused by common errors in installation.

The manufacturer and/or distributor of this product shall not be held responsible for installation actions taken or not taken. There are many details of installation that are assumed to be general construction knowledge of professional installers; which are not included in these instructions. These installation guidelines are intended to be strictly recommendations and are NOT to serve as a step-by-step, fail-safe installation checklist. Selection of an experienced installer is the sole responsibility of the project owner and designer/architect.

Stork Composites do not accept any responsibility for job failure resulting from or associated with improper site environmental conditions.

# STORK

---

## INSTALLATION DETAILS ACCESS FLOORS

Suitable for several loose lay access flooring systems according to the requirements of the European Standard EN 12825, STORK access floors are ideal for offices. Easy access to the underfloor area allows for greater design flexibility, faster construction, workspace reconfiguration and quick repair.

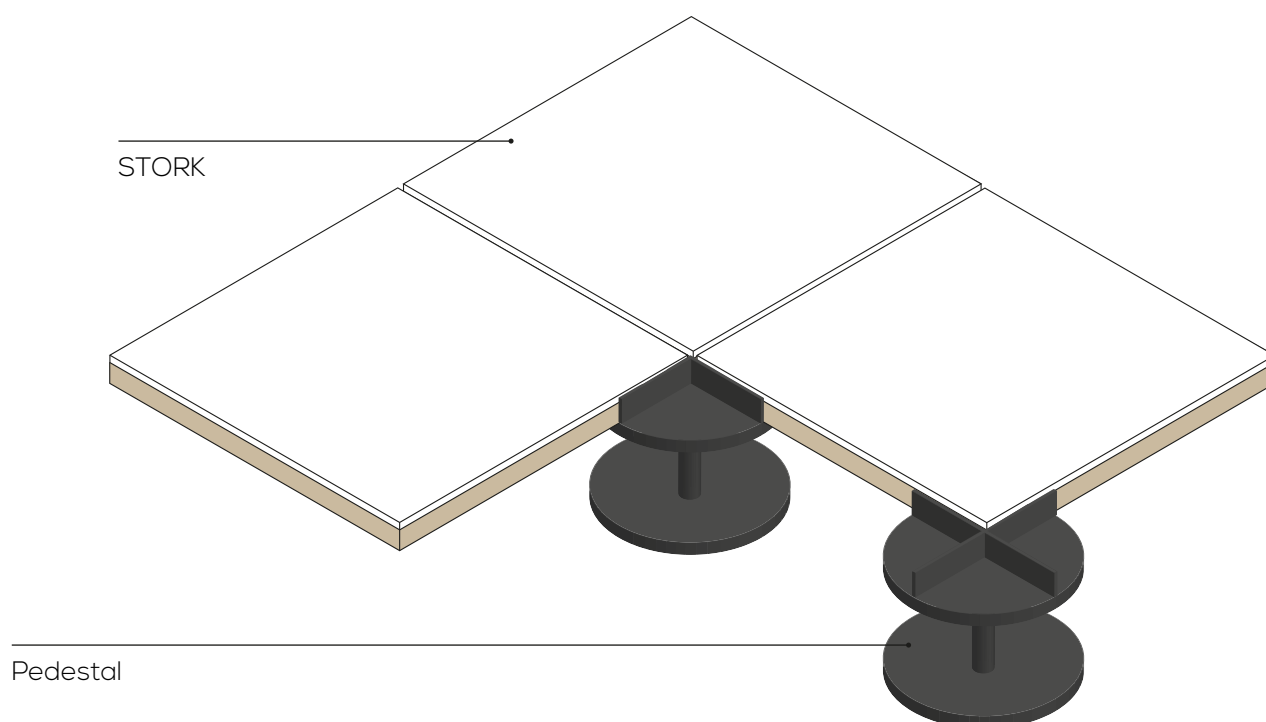

---

### FURTHER QUESTIONS, ADVICE OR REQUESTS? **TALK TO US**

Detailed drawings and recommended texts for tender documentation of the shown examples are available on request. Do you need help or advice on a project? Contact our experienced technical services department – get in touch.

#### **PLEASE READ DISCLAIMERS:**

These guidelines are provided in good faith to help prevent any problems caused by common errors in installation.

The manufacturer and/or distributor of this product shall not be held responsible for installation actions taken or not taken. There are many details of installation that are assumed to be general construction knowledge of professional installers; which are not included in these instructions. These installation guidelines are intended to be strictly recommendations and are NOT to serve as a step-by-step, fail-safe installation checklist. Selection of an experienced installer is the sole responsibility of the project owner and designer/architect.

Stork Composites do not accept any responsibility for job failure resulting from or associated with improper site environmental conditions.

# STORK

---

## INSTALLATION DETAILS CEILINGS

Also an appropriate option for soffits and suspended ceilings, STORK panels achieve a Group 1 fire rating and have great long term thermal properties. Ideal for new and retrofit projects,

STORK is very lightweight and easy to install with invisible anchor systems, making installations fast and simple.

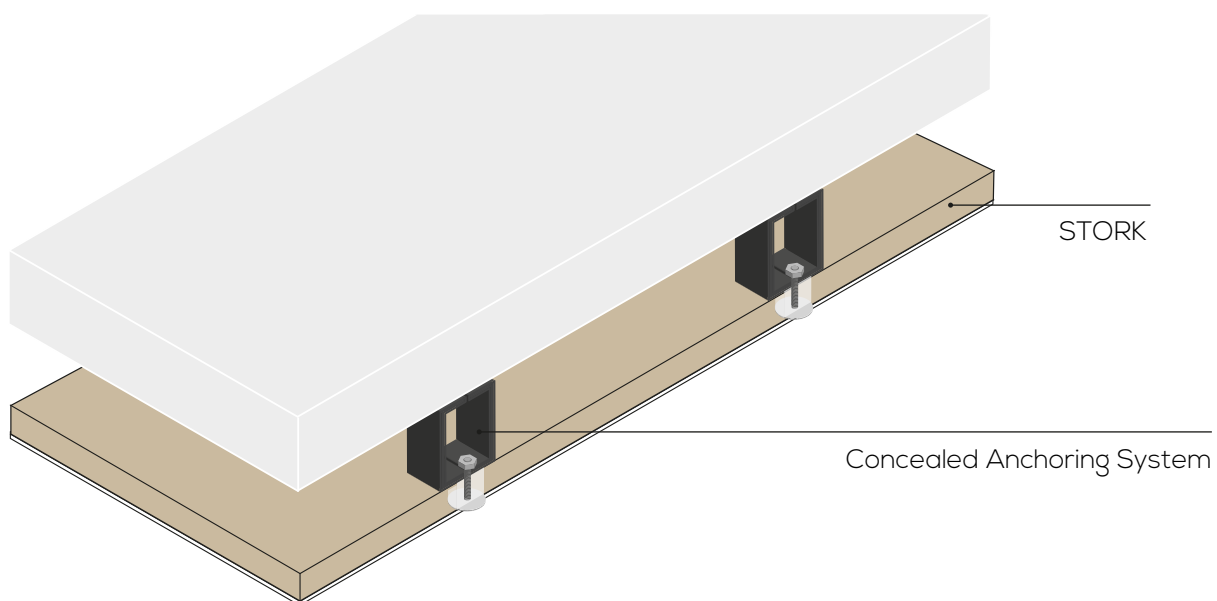

---

### FURTHER QUESTIONS, ADVICE OR REQUESTS? **TALK TO US**

Detailed drawings and recommended texts for tender documentation of the shown examples are available on request. Do you need help or advice on a project? Contact our experienced technical services department – get in touch.

#### **PLEASE READ DISCLAIMERS:**

These guidelines are provided in good faith to help prevent any problems caused by common errors in installation.

The manufacturer and/or distributor of this product shall not be held responsible for installation actions taken or not taken. There are many details of installation that are assumed to be general construction knowledge of professional installers; which are not included in these instructions. These installation guidelines are intended to be strictly recommendations and are NOT to serve as a step-by-step, fail-safe installation checklist. Selection of an experienced installer is the sole responsibility of the project owner and designer/architect.

Stork Composites do not accept any responsibility for job failure resulting from or associated with improper site environmental conditions.

# STORK

---

## INSTALLATION DETAILS INTERIOR WALLS

STORK offer a choice of lightweight wall cladding or partition wall solution for new builds and renovations.

STORK wall panels can be used to improve sound or thermal insulation.

Safe, easy on all types of substrate or partition sub-structure.

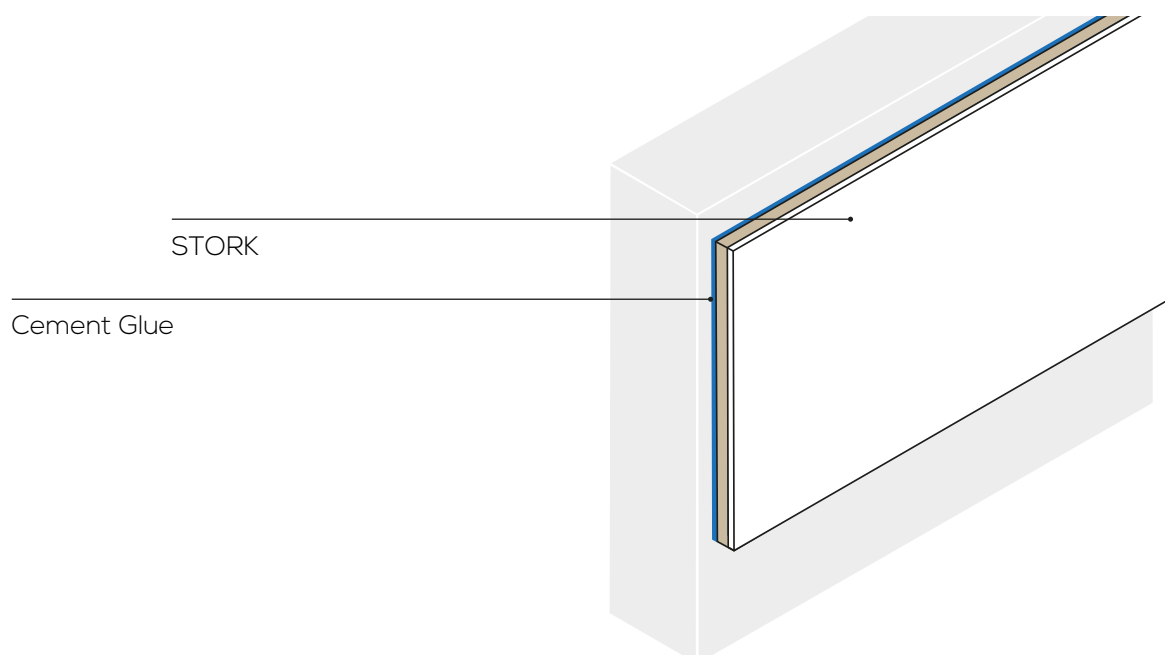

---

### FURTHER QUESTIONS, ADVICE OR REQUESTS? **TALK TO US**

Detailed drawings and recommended texts for tender documentation of the shown examples are available on request. Do you need help or advice on a project? Contact our experienced technical services department – get in touch.

#### **PLEASE READ DISCLAIMERS:**

These guidelines are provided in good faith to help prevent any problems caused by common errors in installation.

The manufacturer and/or distributor of this product shall not be held responsible for installation actions taken or not taken. There are many details of installation that are assumed to be general construction knowledge of professional installers; which are not included in these instructions. These installation guidelines are intended to be strictly recommendations and are NOT to serve as a step-by-step, fail-safe installation checklist. Selection of an experienced installer is the sole responsibility of the project owner and designer/architect.

Stork Composites do not accept any responsibility for job failure resulting from or associated with improper site environmental conditions.

# STORK

---

## INSTALLATION DETAILS VENTILATED FACADES

STORK panels are a versatile cladding for innovative and functional ventilated facade systems, balconies and sunblind solutions.

STORK panels can be used on their own or in combination with other materials. They are perfect to singular effects and textures, to determine the aesthetics and to underline the qualities of a building.

A certified invisible anchoring system makes stork the best solution for every complex cladding project.

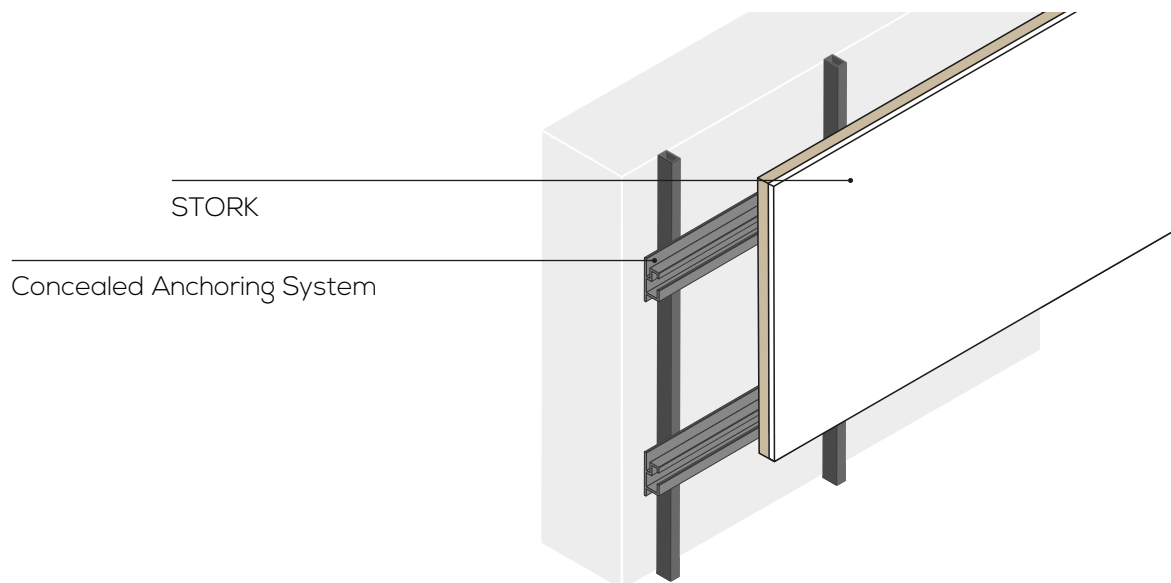

---

### FURTHER QUESTIONS, ADVICE OR REQUESTS? **TALK TO US**

Detailed drawings and recommended texts for tender documentation of the shown examples are available on request. Do you need help or advice on a project? Contact our experienced technical services department – get in touch.

#### **PLEASE READ DISCLAIMERS:**

These guidelines are provided in good faith to help prevent any problems caused by common errors in installation.

The manufacturer and/or distributor of this product shall not be held responsible for installation actions taken or not taken. There are many details of installation that are assumed to be general construction knowledge of professional installers; which are not included in these instructions. These installation guidelines are intended to be strictly recommendations and are NOT to serve as a step-by-step, fail-safe installation checklist. Selection of an experienced installer is the sole responsibility of the project owner and designer/architect.

Stork Composites do not accept any responsibility for job failure resulting from or associated with improper site environmental conditions.